

TAHOE 13FT B

QUICK SETUP INSTRUCTIONS

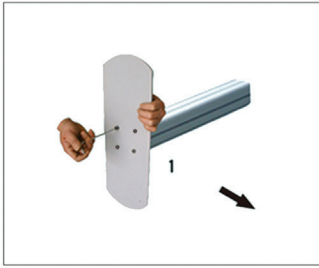

SETUP1

Install both bottom half pole with threads to feet.

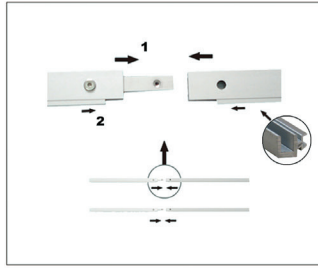

SETUP2

Connect flat bars together.

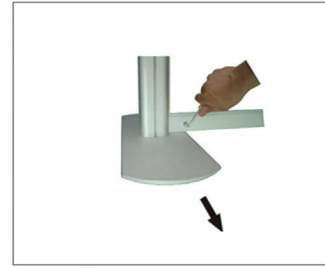

SETUP3

Lock both bottom flat bars onto bottom half poles. Lock bottom side flat bars to bottom half poles.

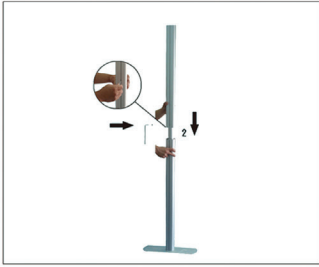

SETUP4

Install top half pole without threads to bottom half pole. Do the same with other side.

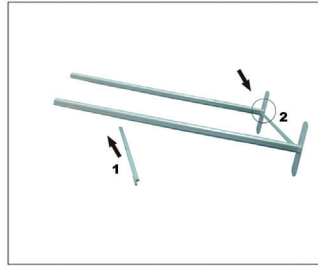

SETUP5

Insert acrylic panel screws to both top flat bars.

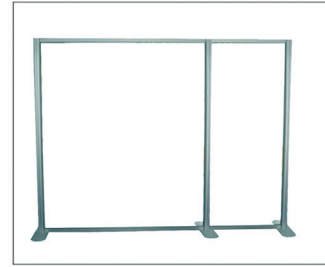

SETUP6

Finish the main profiles.

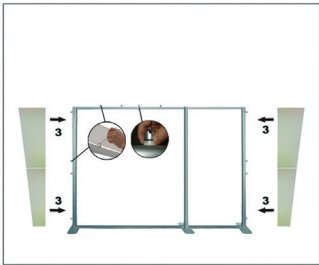

SETUP7

Insert acrylic panels.

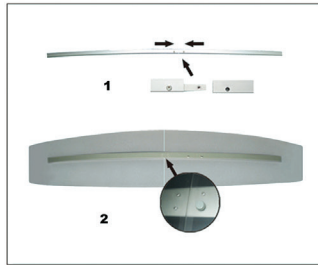

SETUP8

Connect curve rectangle bars and then use the 4 plastic screws to attach the acrylic top canopy panels to the curve rectangle bars.

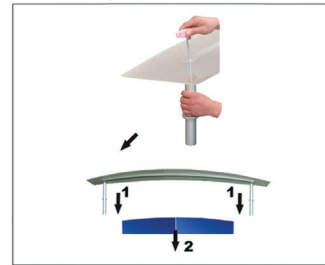

SETUP9

Install roof graphic and connecting supporting Profiles.



SETUP10

Insert printing fabric and lock into place the three aluminum shelves.



SETUP11

Set up table accessories then connect them to main poles with bracket.



SETUP12

Insert the "T" shaped screws and put on the nut. Push the "T" into the profile making sure the "T" screw is in the locking position.

